

Recommendation - worth saving if alienation can be reclaimed. The area is mainly natural and botanically interesting as an example of a coastal bog lake.

Flora - list of collections attached.

Flora of Ambrose Lake
(Seed Plants and Ferns)

I. Rocky shore line, open or with tree cover.

Pseudotsuga menziesii (Mirb.) Franco.

Tsuga heterophylla (Raf.) Sarg.

Thuja plicata Donn.

Pinus contorta Dougl.

Pinus monticola Dougl.

Vaccinium parvifolium Smith

Chimaphila umbellata (L.) Bart

Goodyera oblongifolia Raf.

Gaultheria shallon Pursh

Linnaea borealis L.

Galium aparine L.

Boschniakia strobilacea Gray

Saxifraga ferruginea Graham

Festuca occidentalis Hook.

Asplenium trichomanes L.

Polystichum munitum (Kaulf.) Presl.

Flora of Ambrose Lake
(Seed Plants and Ferns)

II. Peat, either open shore or among shrubs and stunted trees.

- Pseudotsuga menziesii* (Mirb.) Franco.
Tsuga heterophylla (Raf.) Sarg.
Pinus monticola Dougl.
Pinus contorta Dougl.
Picea sitchensis (Bong.) Carr.
Juniperus communis L. (scarce)
Rhamnus purshiana DC, (")
Pyrus fusca Raf. (")
Alnus oregona Nutt. = *A. rubra*
Kalmia polifolia Wang. (very common)
Menziesia ferruginea Smith (scarce)
Myrica gale L. (very common)
Gaultheria shallon Pursh. (very common)
Spiraea douglasii Hook.
Ledum groenlandicum Oeder (very common)
Viola palustris L.
Cornus canadensis L.
Oxycoccus quadripetalus Gilib.
Tofieldia glutinosa (Michx.) Pers.
Cicuta douglasii (DC) Coult. & Rose.
Drosera rotundifolia L.
Hypericum anagalloides C. & S.
Lycopus uniflorus Michx.
Trientalis arctica Fisch. ex Hook. (common)
Lysichitum americanum Hult. & St. J. (common)
Nuphar polysepalum Engelm.
Phragmites communis Trin.
Eriophorum chamissonis Mey.
Dulichium arundinaceum (L.) Britt.
Carex aquatilis Wahl.
C. canescens L.
C. pauciflorus Lightf.

C. cusickii Mack.

C. lasiocarpa Ehrh. var. *americana* Fern.

Pteridium aquilinum (L.) Kuhn.

The list is incomplete partly, of course, because of season or lack of time. However, some conspicuous absences appeared to be real. I looked diligently for:

Drosera anglica Huds.

Andromeda polifolia L.

Seed plants in the water other than Nuphar

Potentilla palustris (L.) Scop.

Rubus chamaemorus L.

Sanguisorba officinalis L.

Vaccinium other than *parvifolium* (which occurred only in the woods).

Nathaniel B. ...

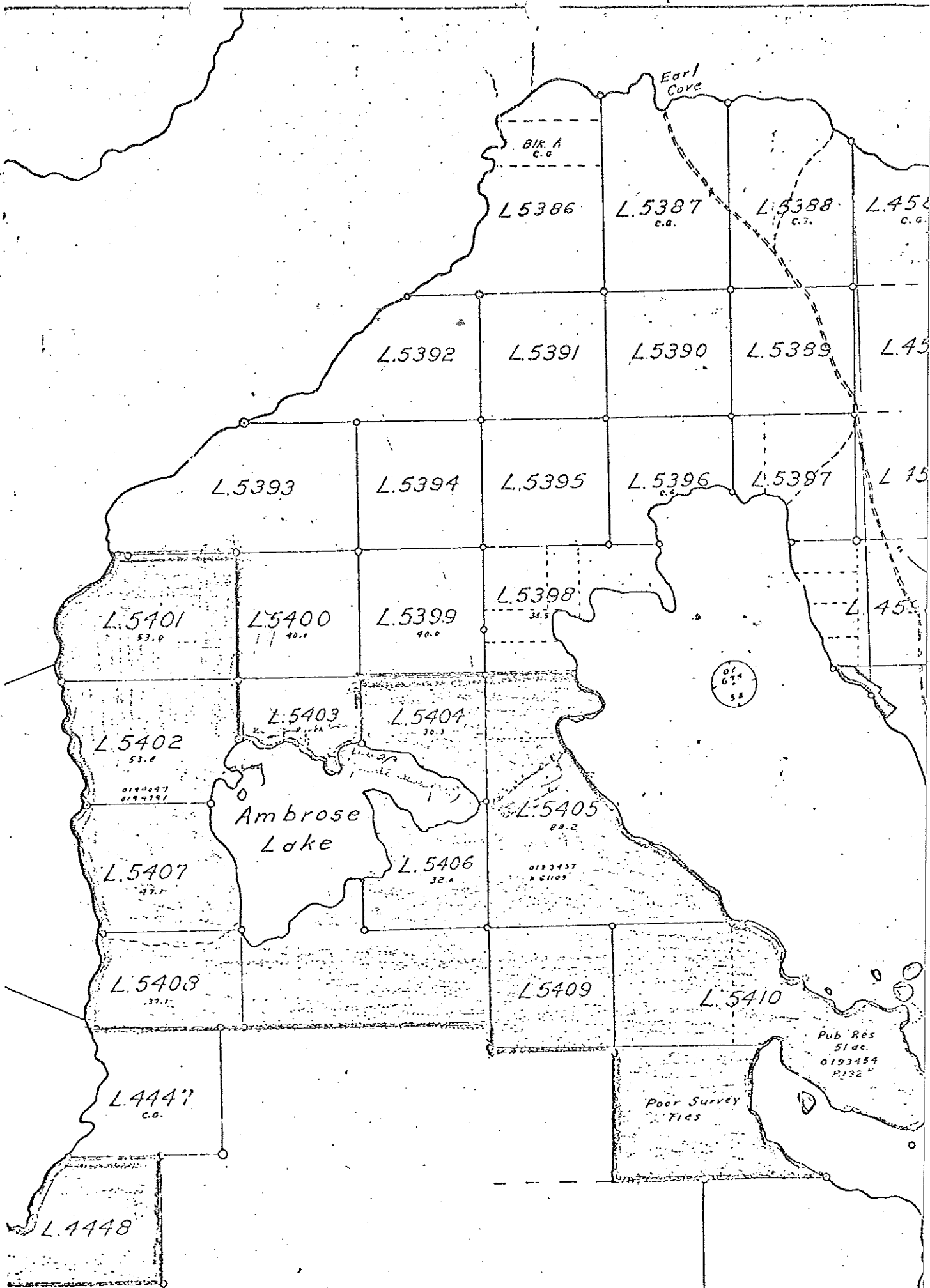

Earl Cove

BIR. A
C.O.

L.5386

L.5387
c.o.

L.5388
c.o.

L.4538
c.o.

L.5392

L.5391

L.5390

L.5389

L.4539

L.5393

L.5394

L.5395

L.5396
c.o.

L.5397

L.4540

L.5401
53.9

L.5400
40.1

L.5399
40.0

L.5398
34.5

L.4541

L.5402
53.6
0190697
0190791

L.5403

L.5404
30.1

02
675
55

Ambrose
Lake

L.5405
88.2
0193157
R 01109

L.5407
37.1

L.5406
32.6

L.5408
37.1

L.5409

L.5410

Pub Res
51 ac.
0193459
P132

L.4447
c.o.

Poor Survey
Ties

L.4448

L.4697

Vascular Plants of E.R. #28 Ambrose Lake

from Pojar, J. May 1977

Milnes, L. & Riley, S. May 1982

Beamish, K.I. 1968

— Acer macrophyllum	Galium aparine	— Thuja plicata
Adiantum pedatum	Gaultheria shallon	Tofieldia glutinosa
Agrostis scabra	Gentiana sceptrum	Trientalis arctica
— Alnus rubra	Goodyera oblongifolia	Trientalis latifolia
Apargidium boreale	Hypericum anagalloides	— Tsuga heterophylla
— Arbutus menziesii	Hypopitys monotropa	Vaccinium oxycoccus
Arctostaphylos columbiana	Kalmia polifolia	Vaccinium parvifolium
Arctostaphylos media	Ledum groenlandicum	Vaccinium uliginosum
Arctostaphylos uva-ursi	Linnaea borealis	Viola glabella
Asplenium trichomanes	Luzula campestris	Viola howellii
Berberis nervosa	Lycopus uniflorus	Viola palustris
Blechnum spicant	Lysichitum americanum	Zygadenus venenosus
Boschniakia hookeri	Menziesia ferruginea	
Carex aquatilis	Microsteris gracilis	
Carex canescens	Mimulus moschatus	
Carex cusickii	Myrica gale	
Carex lasiocarpa var. americana	Nuphar polysepalum	
Carex livida	Oenanthe sarmentosa	
Carex obnupta	Phragmites communis	
Carex pauciflorus	— Picea sitchensis	
Carex sitchensis	— Pinus contorta	
Chimaphila menziesii	— Pinus monticola	
Chimaphila umbellata	Polystichum munitum	
Cicuta douglasii	— Pseudotsuga menziesii	
Cornus canadensis	Pteridium aquilinum	
— Cornus nuttallii	— Pyrus fusca	
Cryptogramma crispa	— Rhamnus purshiana ^{1/5}	
Deschampsia caespitosa	Rosa nutkana	
Drosera rotundifolia	Salix sp ¹	
Dulichium arundinaceum	Saxifraga ferruginea	
Eriophorum chamissonis	Selaginella wallacei	
Festuca occidentalis	Spiraea douglasii	
Fragaria virginiana		

<i>Atrichum selwynii</i>	<i>Polytrichum commune</i>
<i>Brachythecium asperrimum</i>	<i>Polytrichum juniperinum</i>
<i>Ceratodon purpureus</i>	<i>Polytrichum piliferum</i>
<i>Claopodium crispifolium</i>	<i>Racomitrium canescens</i>
<i>Dicranum ?muhlenbeckii</i>	<i>Rhytidiadelphus loreus</i>
<i>Eurhynchium oreganum</i>	<i>Rhytidiadelphus squarrosus</i>
<i>Hookeria lucens</i>	<i>Rhytidiadelphus triquetrus</i>
<i>Hylocomium splendens</i>	<i>Sphagnum fuscum</i>
<i>Mnium glabrescens</i>	<i>Sphagnum papillosum</i>
<i>Plagiothecium undulatum</i>	<i>Sphagnum rubellum</i>
<i>Pleurozium schreberi</i>	<i>Stokesiella oregana</i>
	<i>Timmia austriaca</i>

Liverworts of E.R. #28 Ambrose Lake

Blasia pucilla
Cephalozia sp.
Lepidozia reptans
Plagiochila sp.
Porella sp.
Scapania undulata

Lichens of E.R. #28 Ambrose Lake

Cladonia bellidiflora
Cladonia furcata
Cladonia gracilis
Cladonia mitis
Cladonia rangiferina
Cladonia uncialis

<i>Acer macrophyllum</i>	big-leafed maple
<i>Adiantum pedatum</i>	maidenhair fern
<i>Agrostis scabra</i>	tickle grass
<i>Alnus rubra</i>	red alder
<i>Apargidium boreale</i>	apargidium
<i>Arbutus menziesii</i>	arbutus
<i>Arctostaphylos columbiana</i>	manzanita
<i>Arctostaphylos media</i>	hybrid between manzanita & kinnikinick
<i>Arctostaphylos uva-ursi</i>	kinnikinick
<i>Asplenium trichomanes</i>	maidenhair spleenwort
<i>Berberis nervosa</i>	Oregongrape
<i>Blechnum spicant</i>	deerfern
<i>Boschniakia hookeri</i>	ground-cone
<i>Carex aquatilis</i>	water sedge
<i>Carex canescens</i>	gray sedge
<i>Carex cusickii</i>	Cusick's sedge
<i>Carex lasiocarpa</i> var. <i>americana</i>	slender sedge
<i>Carex livida</i>	pale sedge
<i>Carex obnupta</i>	slough sedge
<i>Carex pauciflorus</i>	few-flowered sedge
<i>Carex sitchensis</i>	Sitka sedge
<i>Chimaphila menziesii</i>	little prince's pine
<i>Chimaphila umbellata</i>	pipsissewa
<i>Cicuta douglasii</i>	Douglas' water-hemlock
<i>Cornus canadensis</i>	bunchberry
<i>Cornus nuttallii</i>	Pacific dogwood
<i>Cryptogramma crispa</i>	parsley-fern
<i>Deschampsia caespitosa</i>	tufted hairgrass
<i>Drosera rotundifolia</i>	sundew
<i>Dulichium arundinaceum</i>	dulichium
<i>Eriophorum chamissonis</i>	bog cotton
<i>Festuca occidentalis</i>	western fescue
<i>Fragaria virginiana</i>	strawberry

<i>Galium aparine</i>	cleavers
<i>Gaultheria shallon</i>	salal
<i>Gentiana sceptrum</i>	staff gentian
<i>Goodyera oblongifolia</i>	rattlesnake plantain
<i>Hypericum anagalloides</i>	bog St. John's wort
<i>Hypopitys monotropa</i>	fringed pinesap
<i>Kalmia polifolia</i>	western swamp laurel
<i>Ledum groenlandicum</i>	Labrador tea
<i>Linnaea borealis</i>	twinflower
<i>Luzula campestris</i>	field woodrush
<i>Lycopus uniflorus</i>	northern bugleweed
<i>Lysichitum americanum</i>	swamp lantern
<i>Menziesia ferruginea</i>	false azalea
<i>Microsteris gracilis</i>	pink microsteris
<i>Mimulus moschatus</i>	muskflower
<i>Myrica gale</i>	sweet gale
<i>Nuphar polysepalum</i>	spatterdock
<i>Oenanthe sarmentosa</i>	Pacific water-parsley
<i>Phragmites communis</i>	common reed
<i>Picea sitchensis</i>	Sitka spruce
<i>Pinus contorta</i>	shore pine
<i>Pinus monticola</i>	western white pine
<i>Polystichum munitum</i>	swordfern
<i>Pseudotsuga menziesii</i>	Douglas fir
<i>Pteridium aquilinum</i>	bracken-fern
<i>Pyrus fusca</i>	western crabapple
<i>Rhamnus purshiana</i>	cascara
<i>Rosa nutkana</i>	Nootka rose
<i>Salix sp</i>	willow
<i>Saxifraga ferruginea</i>	rusty saxifrage
<i>Selaginella wallacei</i>	Wallace's selaginella
<i>Spiraea douglasii</i>	hardhack

<i>Thuja plicata</i>	western red cedar
<i>Tofieldia glutinosa</i>	sticky tofieldia
<i>Trientalis arctica</i>	northern starflower
<i>Trientalis latifolia</i>	western starflower
<i>Tsuga heterophylla</i>	lowland hemlock
<i>Vaccinium oxycoccus</i>	cranberry
<i>Vaccinium parvifolium</i>	red huckleberry
<i>Vaccinium uliginosum</i>	bog bilberry
<i>Viola glabella</i>	stream violet
<i>Viola howellii</i>	Howell's violet
<i>Viola palustris</i>	marsh violet
<i>Zygadenus venenosus</i>	death-camass